

FOR SALE

2A BULL RING HIGH STREET, NORTHWICH, CHESHIRE, CW9 5BU



LOCATION

2A BULL RING HIGH STREET, NORTHWICH, CHESHIRE, CW9 5BU

LOCATED IN THE HEART OF NORTHWICH TOWN CENTRE, 2A BULL RING ENJOYS A HIGHLY PROMINENT AND ACCESSIBLE POSITION WITHIN ONE OF CHESHIRE'S MOST VIBRANT MARKET TOWNS. NORTHWICH IS RENOWNED FOR ITS RICH HERITAGE, ATTRACTIVE WATERWAYS AND ONGOING REGENERATION, MAKING IT AN INCREASINGLY DESIRABLE DESTINATION FOR BOTH BUSINESSES AND VISITORS. THE PROPERTY SITS JUST MOMENTS FROM A WIDE RANGE OF AMENITIES, INCLUDING THE POPULAR BARONS QUAY, WHICH OFFERS A MIX OF RETAIL, DINING AND LEISURE FACILITIES SUCH AS A CINEMA, RESTAURANTS AND NATIONAL BRANDS. EXCELLENT TRANSPORT CONNECTIVITY ENHANCES THE APPEAL OF THIS LOCATION. NORTHWICH IS WELL POSITIONED WITHIN THE CHESHIRE REGION, WITH CONVENIENT ROAD LINKS VIA THE A556 AND A559, PROVIDING EASY ACCESS TO CHESTER, WARRINGTON AND MANCHESTER. NORTHWICH RAILWAY STATION IS WITHIN WALKING DISTANCE, OFFERING REGULAR SERVICES TO KEY REGIONAL DESTINATIONS.



PHOTOS



2A BULL RING HIGH STREET, NORTHWICH, CHESHIRE, CW9 5BU



FLOORPLAN



2A BULL RING HIGH STREET, NORTHWICH, CHESHIRE, CW9 5BU

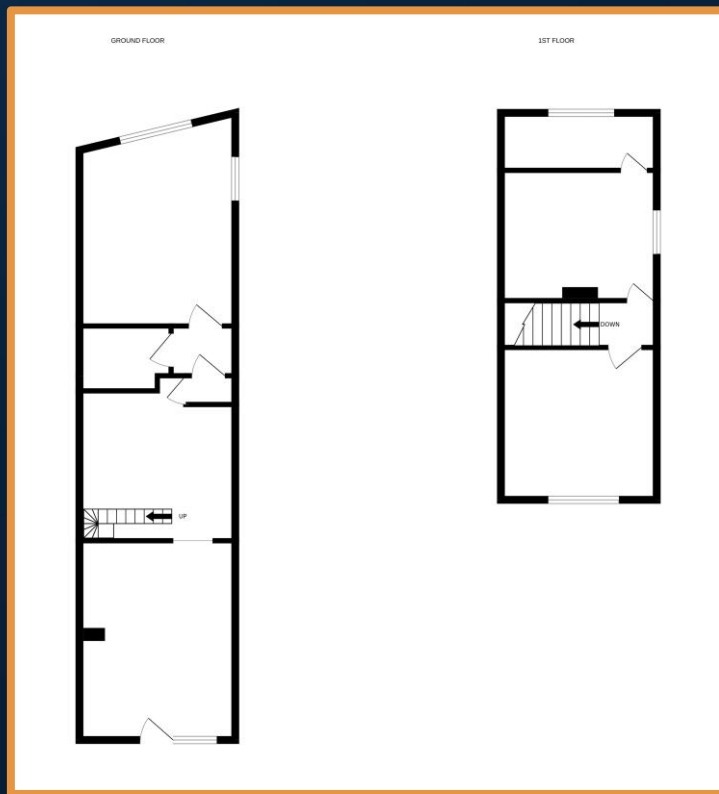

DETAILS



2A BULL RING HIGH STREET, NORTHWICH, CHESHIRE, CW9 5BU

DESCRIPTION

- PROMINENT LOCATION IN NORTHWICH TOWN CENTRE
- TOTAL ACCOMMODATION – 725 SQ.FT
- SUITABLE FOR MULTIPLE USES SUBJECT TO THE RELEVANT PLANNING BEING ACHIEVED
- EXCELLENT TRANSPORT LINKS
- CLOSE TO AMENITIES

TERMS OF LEASE

- FREEHOLD

LEGAL COSTS

- EACH PARTY IS RESPONSIBLE FOR PAYING THEIR OWN LEGAL COSTS

PRICE

- £75,000 (WE UNDERSTAND THERE IS NO VAT PAYABLE)

ENQUIRIES



2A BULL RING HIGH STREET, NORTHWICH, CHESHIRE, CW9 5BU

 SUITE 7, OAK TREE BARN, HATTON LANE, HATTON, WA4 4BX

 JORDAN@READPROPERTY.INFO

 WWW.READPROPERTIES.CO.UK

 01925 213987



zoopla

